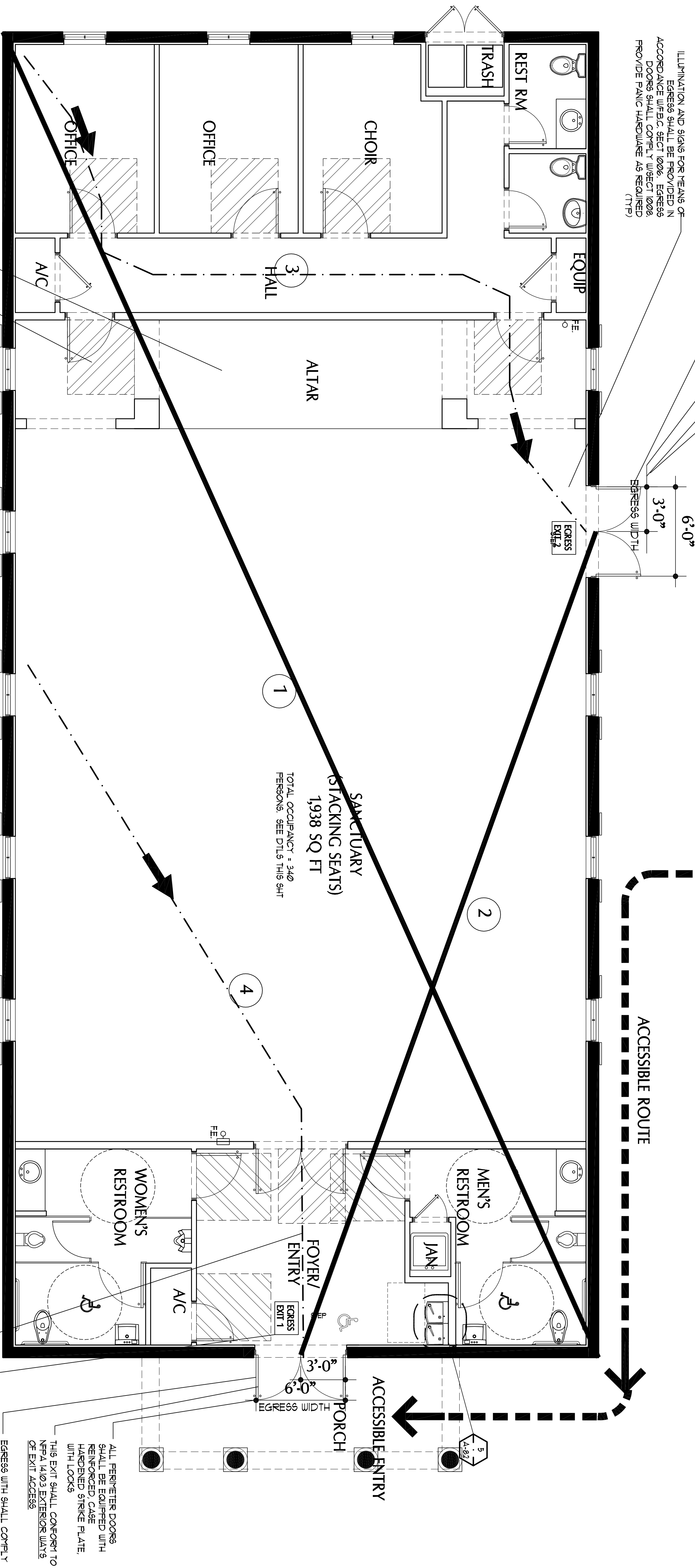

GROUP A-3 ASSEMBLY	100	300	20	0.2	0.3	44	32	44
OCCUPANCY CLASSIFICATION	MANUFACT. DIST TO EXH (F)	MANUFACT. DIST TO EXH (F)	MAX DEAD END COR. LENGTH (FT)	EXCEEDS WIDTH PER PERSON SERVED (N)	EXCEEDS WIDTH PER PERSON SERVED (N)	NM CORRIDOR AREA WIDTH (IN)	NM CLERK DOORS (IN)	NM STAIR WIDTH (IN)
	FEC. TABLE (W&L)	FEC. TABLE (W&L)		TABLE (W&L) FEC	TABLE (W&L) FEC	0.012 FEC		
	UN SPARK	UN SPARK		LEVEL	STAIRS			

BUILDING COMPLIANCE AS PER TABLE 603.5 IBC 2007 MINIMUM INTERIOR FINISH CLASSIFICATION	
	WITHOUT SPRINKLER SYSTEM
OCCUPANCY CLASSIFICATION	EXIT ENCLOSURES AND EXIT OTHER EXITS**
GROUP A-1 GROUP A-2 GROUP A-3	CLASS A: 1/2" PLATE GROUND 0-351 SMOKE DEVELOPED 0-450
LOBBY AREA'S GROUP A-1 GROUP A-2 GROUP A-3 OCCUPANCIES SHALL NOT BE LESS THAN CLASS B MATERIALS	CLASS C: 1/2" PLATE GROUND 0-300 SMOKE DEVELOPED 0-450

OCCUPANCY CLASSIFICATION	NUMBER OF LIVING UNITS REQUIRED PER SEC. 407.1.02.3 PLUMBING CODE							
	WATER CLOSERS		LAVATOIRES		SHOWER	DRINKING FOUNTAIN	SERVICE SINK	REPAIRS
GROUP A-3 ASSEMBLY	MALE 1 PER 50	FEMALE 1 PER 5	1 PER 100		N/A	1 PER 1000	N/A	50% WATER CLOSER
REQUIRED	34	271	34	MALE FEMALE	N/A	1	1	0
PROVIDED	2 TOILETS, 1 URINAL AND 1 PRIVATE RESTROOM		2 TOILETS, 1 FEMALE AND 1 PRIVATE RESTROOMS		N/A	1	1	1

BASED ON TOTAL OCCUPANCY = 340

[illegible]

OCCUPANCY			
OCCUPANCY AREA BY GROUP D-3			
FLOOR OR WORKSHOP AREA PER SECTION 304 FBC			
OCCUPANCY LOAD AS PER TABLE 1004.1A FBC 2007H1	50 FT	REQUIRED	TOTAL
FUNCTION OF SPACE			
ENTRY	204	5	408
RECEPTION/HALL/BUSINESS AREA/5	114	10	114
RECEPTION/HALL/BUSINESS AREA/6	1938	1 NET	216.85
STORAGE/PLANTORY	61	15	1013
STORAGE/MECHANICAL	83	300	28
TOTAL	3560 SF		3404
OCCUPANCY LOAD AS PER TABLE 1002.1A FBC			
FUNCTION OF SPACE	50 FT	REQUIRED	TOTAL
ENTRY/Waiting (PER NFPA 901.7)	204	3	60
RECEPTION/HALL/BUSINESS AREA/5	114	100	114
RECEPTION/HALL/BUSINESS AREA/6	1938	1 NET	216.85
STORAGE/PLANTORY	61	15	1013
STORAGE/MECHANICAL	83	500	11
TOTAL	3560 SF		3614.9

2	OCCUPANCY LOAD
---	----------------

[illegible][illegible]

4	KEY NOTES
NFPA	NFPA 1021 (WHERE MORE THAN ONE EXIT IS REQUIRED FROM A BUILDING OR PORTION THEREOF) SHALL EXITS SHALL BE SEPARATELY LOCATED FROM EACH OTHER AND SHALL BE SEPARATED AND CONSTRUCTED TO MEET THE REQUIREMENTS OF NFPA 1021. EXITS SHALL NOT BE BLOCKED BY ANY ONE FIRE OR OBSTACLES IN ANY CONDITION.
NFPA 1032	NFPA 1032 (WHERE TWO EXIT OR EXIT ACCESS DOORS ARE REQUIRED FROM A BUILDING OR PORTION THEREOF) SHALL BE SEPARATED FROM EACH OTHER AND SHALL BE SEPARATED AND CONSTRUCTED TO MEET THE REQUIREMENTS OF NFPA 1032. EXITS SHALL BE SEPARATED BY A STRAIGHT LINE FROM THE NEAREST EXIT DOOR.
NFPA 1033	NFPA 1033 IN BUILDINGS PROTECTED THROUGH BY AN APPROVED AUTOMATIC SPRINKLER SYSTEM IN ACCORDANCE WITH SECTION 9.3, THE MINIMUM SEPARATION DISTANCE BETWEEN TWO EXITS SHALL BE NOT LESS THAN 5 FEET DIAGONAL.
5	NFPA SECTIONS

**IN-SITE  
DESIGN  
GROUP INC**

1601 ROMAN STREET  
HOLLYWOOD, FLORIDA 33020  
AA28001759  
954 921 5333  
FAX 954 921 6769  
PROJECT COORDINATOR:  
ANNE CARLUETHERS  
OGC 1511088  
ARCHITECT  
SAMUEL R. UCCELLO

THESE FIGURES AND PLANNING ARE THE  
PROPERTY OF DESIGN GROUP INC. AND ARE  
FOR THE EXCLUSIVE USE OF THE CLIENT.  
THEY ARE NOT TO BE REPRODUCED OR  
DISTRIBUTED IN ANY MANNER WITHOUT  
THE WRITTEN PERMISSION OF DESIGN  
GROUP INC. ANY VIOLATION OF THIS  
AGREEMENT WILL BE CONSIDERED A  
BREACH OF CONTRACT AND WILL BE  
PUNISHED BY LAW.

STATE OF FLORIDA LICENSE NO. RA-0318997

SEFL

NEW LIFE PENTECOSTAL  
CHURCH MIRACLE  
CENTER



ADDRESS:  
6136 VAN BUREN STREET  
HOLLYWOOD, FL

REVISIONS  
JUNE-6-11  
SUBMITTAL TO  
TECHNICAL ADVISORY  
COMMITTEE

Date Of Issue  
JUNE-6-11

LIFE SAFETY

A-1.2